

SIMEX Setup and Transportation Instructions

STEP 1:

Disposable Canister "Liner" Visual Assembly Instructions

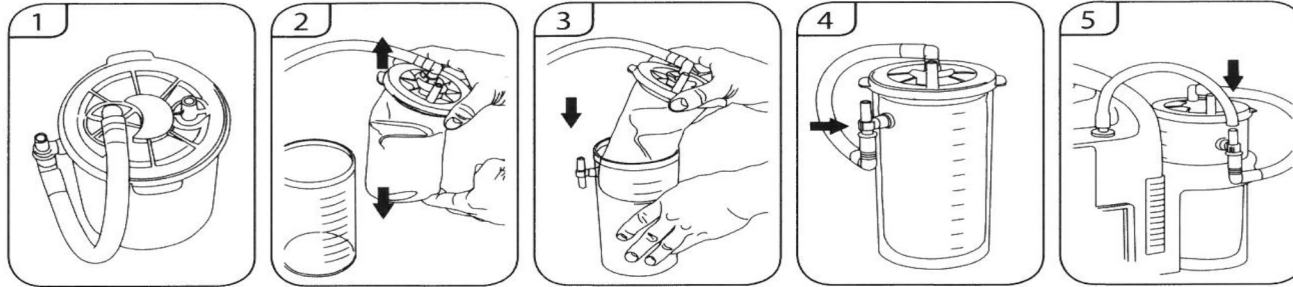

- Read Instructions for Use prior to operating
- Protection class II

- Degree of protection: **Type BF** (Body Floating)
- Equipment must not be disposed of with household waste

A leaf in the external canister or at the lid of the disposable liner may cause air to flow into the external canister. This may lead to the collapse of the disposable liner.

Inspect the disposable secretion canister system (1,000 ml) to ensure that the lid of the disposable liner is firmly connected to the external canister.

Ensure that all connections are firmly connected to the external canister.

Ensure that all external canister is undamaged and the T-piece is firmly attached.

Follow the instructions for the use supplied by the manufacturer.

STEP 2:

BEFORE putting Simex machine on a patient - Set up machine settings based upon facility approved Algorithm.
Once settings are entered, Press OK to pause machine.

STEP 3:

Attach sterile PVC suction tubing to patient subglottic port.

STEP 4:

Once everything is properly connected, Turn **ON** machine by pressing **OK**

* If machine locks out, Press **BOTH ARROWS** simultaneously to unlock.

* IF **TRANSPORTING PATIENTS** - **PAUSE** machine by pushing **OK**

1. Clamp and Cap Sterile Tubing

2. Transport patient and reset machine

FOR QUESTIONS CONTACT SUPPORT 800.206.9147